

Charles Road Cowes, PO31 8HG

£340,000



A beautifully presented modern 3 bedroom bungalow ideally located in Cowes. Close to local schools and transport links! This is the perfect modern home consisting of two good-sized single bedrooms followed by one double bedroom with double-glazed french doors looking out on to the garden/decking. Followed by a good-sized family bathroom, kitchen with storage and electric cooker and a spacious living/dining room. Outside is beautifully presented consisting of a good-sized decking area, two patio areas, Summer house and garden shed. Other benefits From a driveway for multiple cars, garage with an electric door and double glazing.

BEAUTIFULLY PRESENTED MODERN
BUNGALOW

ENCLOSED REAR GARDEN WITH SUMMER
HOUSE

WALKING DISTANCE TO THE RANGE

GARAGE AND OFF ROAD PARKING

CLOSE TO LOCAL SCHOOLS

LOCATED WITHIN A QUIET COMMUNITY

ROOMS

Bedroom 2 9' 0" x 9' 0" (2.75m x 2.74m)

Built in Wardrobe (Removable). Carpeted Flooring. Double glazing & Radiator.

Bedroom 1 12' 0" x 9' 0" (3.66m x 2.74m)

Carpeted Flooring. Double glazed french doors to rear aspect leading on the garden decking. Radiator.

Bedroom 3 8' 0" x 7' 11" (2.45m x 2.42m)

Laminate flooring. Double glazed window to side aspect & Radiator.

Bathroom 5' 0" x 5' 10" (1.52m x 1.78m)

Double glazed frosted window to side aspect. Bath with over shower. Walk-in Shower. Sink & WC. Heated towel rail.

Kitchen 8' 10" x 10' 11" (2.70m x 3.34m)

Double glazed window to side aspect & door leading to side access. Electric oven and cooker. Fitted wall base & drawer units. Sink & drainer.

Lounge/Diner 21' 0" x 11' 10" (6.41m x 3.61m)

Spacious Lounge/diner. Double glazed windows to front aspect & side aspect. Electric radiator.

Summer house

Garage

Electric door. Full length Garage. Entrance to driveway.

Entrance Hall

Bright entrance hall. Built in cloakroom with sliding doors. Access to all rooms in the bungalow.

GROUND FLOOR

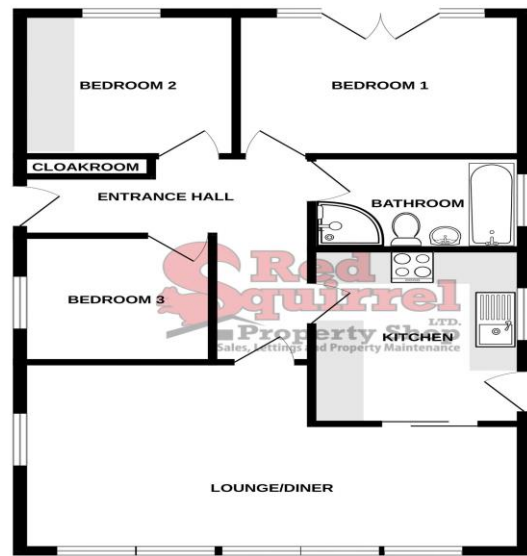

Whilst every attempt has been made to ensure the accuracy of the floorplans contained herein, measurements of doors, windows, rooms and any other items are approximate and no responsibility is taken for any error, omission or mis-statement. This plan is for illustrative purposes only and should be used as such by any prospective purchaser. The fixtures, systems and appliances shown have not been tested and no guarantee as to their operability or efficiency can be given. Made with Metropix ©2023

